

Windshield Wash and Coolant Dispense

Diaphragm Pump Specialty Packages

Packages for Pre-Mixed Windshield Wash Solvent and Coolant Dispense

307 Air-Operated Double-Diaphragm Pump	
237161	Complete package includes the following: 307 Diaphragm Pump (D31255), 6 ft (1.8 m) air hose (109125), 4 ft (1.2 m) coupled nitrile fluid hose (220596), air filter (110146), air gauge (108190), air line fitting (111511), 1/4 npt air regulator (110318), elbow (100611), 15 in (381 mm) 3/8 in ID tube, (187479), mounting bracket (190125), adapter (156022), 1/4-18 npt nipple (156971), suction hose kit (223888), 6 ft (1.8 m) coupled PVC hose and 304 SST 16 mesh strainer, wall bracket (224835)
237160	Includes all items listed above except diaphragm pump and wall bracket

Diaphragm Pumps and Accessories

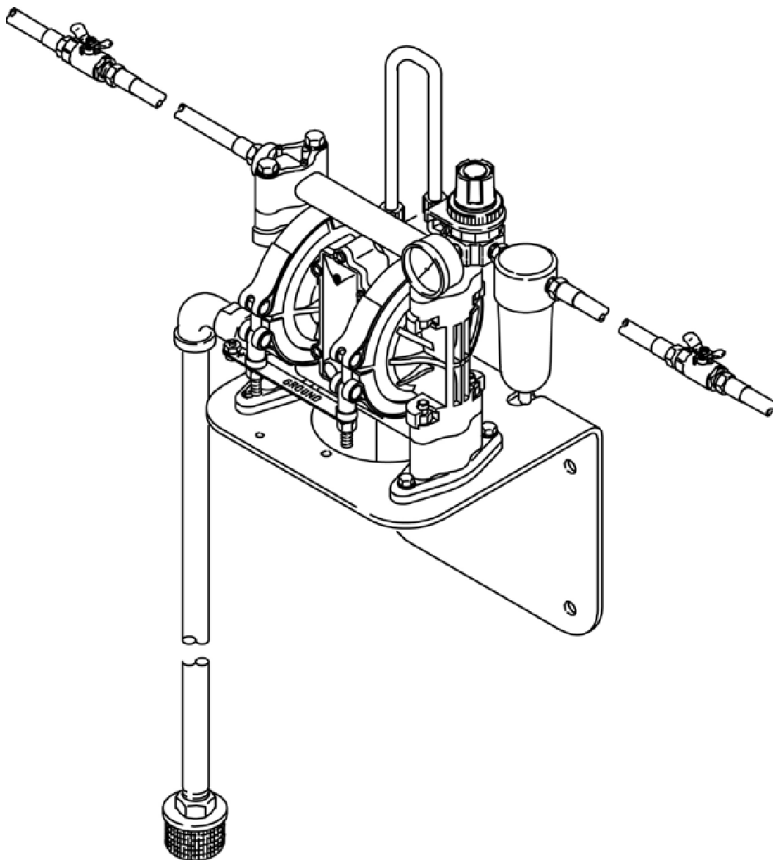

Bulk Anti-Freeze and Windshield Solvent Transfer Packages

Description	1050 A0DD	1050 A0DD	515 A0DD	716 A0DD
	Dual Inlet	Single Inlet	Dual Inlet	Single Inlet
Package Number	244679	244680	244681	244682
Pump	647016	647016	243669	241906
Air Regulator	109075	109075	110147	110147
Fluid Connect Hose	115042	115042	109105	109105
Air Connect Hose	205418	205418	109125	109125
Air Shut-off Valve	110224	110224	110223	110223
Wall Mount Bracket	24C637	24C637	224835	224835
Dual Inlet Manifold	24D147	-	-	-
Suction Kit	2-236054	236054	2-236054	236054
Thermal Relief Kit	238428	238428	113497	113497
Instruction Manual	309353	309353	309353	309353

Fast-Flo® 1:1

Transfer Pumps and Accessories

Features and Benefits

- Differential air motor for smooth operation and reliability
- Stainless steel models available for corrosion resistance

Typical Applications

- Low pressure, high volume transfer of low viscosity fluids
- Automotive dealerships
- Heavy-duty dealerships
- Fast lube centers
- Fleet service facilities
- Service shops
- In-plant
- Lube trucks
- Mining

Typical Fluids Handled

- Water
- Anti-freeze
- Windshield wash fluid
- Used oil
- Used anti-freeze

NOTE: Use Fast-Ball 1:1 for petroleum-based products.

Technical Specifications

Flow Rate gpm (lpm)	5 (19)
Maximum Fluid Pressure psi (bar)	180 (12.4)
Operating Range ⁽¹⁾ psi (bar)	40-180 (2.8-12)
Wetted Materials	See Ordering Info
Air Inlet Size	1/4 npt(f)
Material Inlet ⁽²⁾	1-1/2 npt(f)
Material Outlet	3/4 npt(f)
Line Length ‡	Up to 100 ft (30 m)
Dispense Points	1
Annual Usage	Up to 5000 gal (18921 l)

(1) Max Operating Air Pressure for 226951 is 60 psi (4.2 bar)

(2) For universal pumps

‡ Consult your local authorized Graco representative for line or pipe sizing

Pump Performance

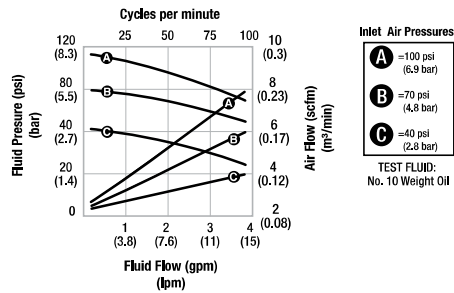

Transfer Pumps and Accessories